

Weitere Antennenhalter aus unserem Sortiment:

Reling Antennenhalter
2DRH



Saugfuß Antennenhalter
2DSH



Magnet Antennenhalter
2DKM



Kippgelenk
Antennenhalter 2DK



Antennenhalter für vertikale und horizontale Mastmontage

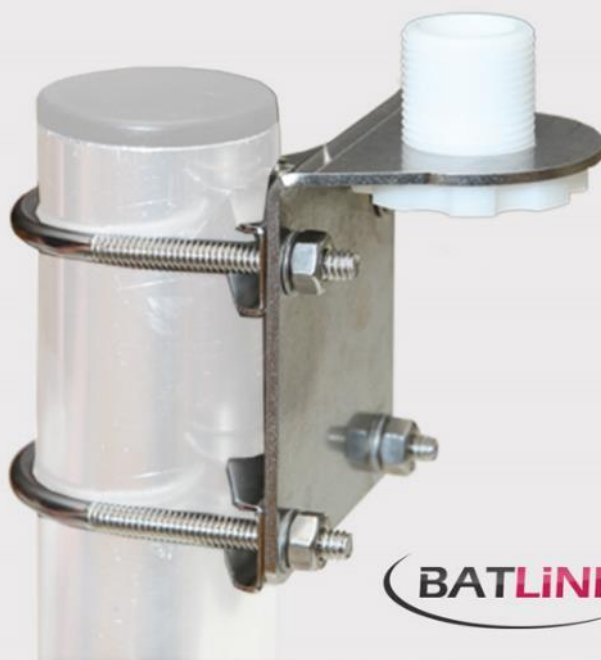

BATLINK

BATLINK Antennentechnik
Am Heilbrunnen 117
72766 Reutlingen / Germany

www.batlink.de Modell: **MH1**

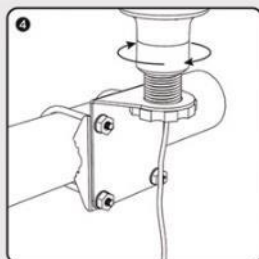
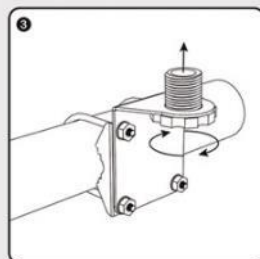
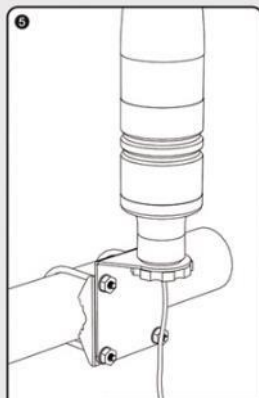
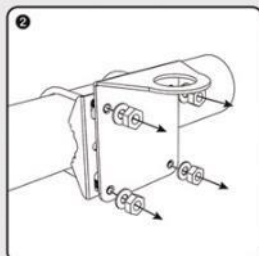
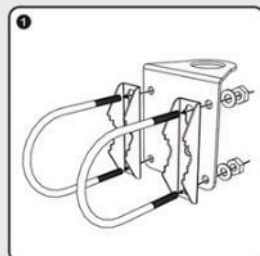

Montageanleitung

Edelstahl Mastmontage-Winkel.

Passend für TravelConnector und alle Antennen mit
1"x14 BFS-Gewinde.

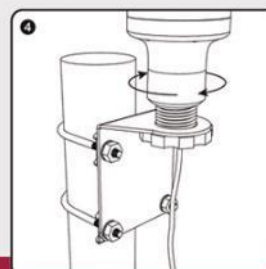
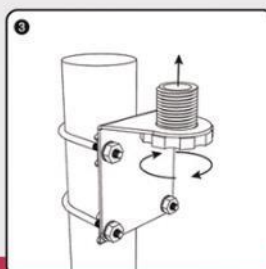
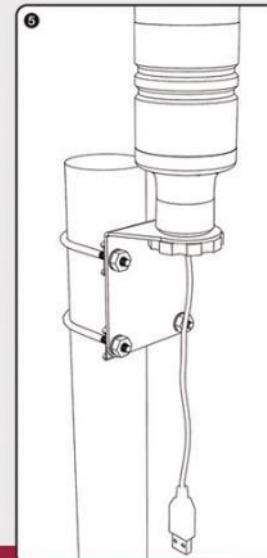
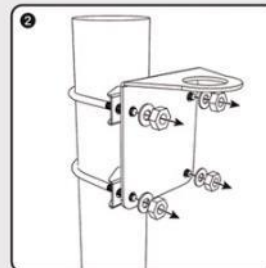
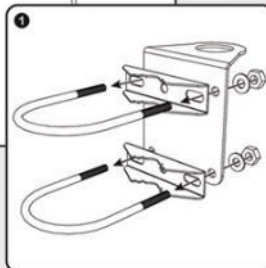

- TYP: MH1
- Schwenkbereich : 360° / VH
- Material: Edelstahl V2A / Pom
- Klemmbereich: 22-50 mm
- Gewinde: 1" 14 Gänge BFS
- Gewicht: 265g

BATLINK

www.batlink.de

CE 
Made in China